

SPRING WALL E26

rev. 0

Design: Eva Zeisel

Codice: 0705363365252 bianco/bianco
0705363365352 bianco/ambra

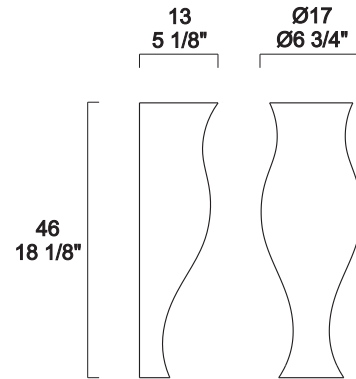

WARNING:

- DISCONNECT POWER BEFORE STARTING INSTALLATION OF FIXTURE.
- INSTALL IN ACCORDANCE WITH THE NATIONAL AND LOCAL CODES.
- FOLLOW DIRECTIONS CAREFULLY TO AVOID SCRATCHING THE GLASS DIFFUSER.

TECHNICAL DATA

1 X MAX 100W
E26 TYPE A
120V / 60Hz

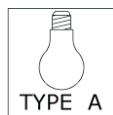

LOCATION

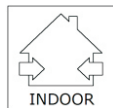

ASSEMBLY INSTRUCTIONS

L E U C O S[®]

SPRING WALL E26

Designed by: Eva Zeisel

LEUCOS USA

11 Mayfield Avenue

Edison, NJ 08837 USA

Phone (732) 225-0010 Fax (732) 225-0250

info@leucosusa.com

www.leucosusa.com



FOLLOW THE ASSEMBLY INSTRUCTIONS BY READING THE NUMERICAL PROGRESSION.

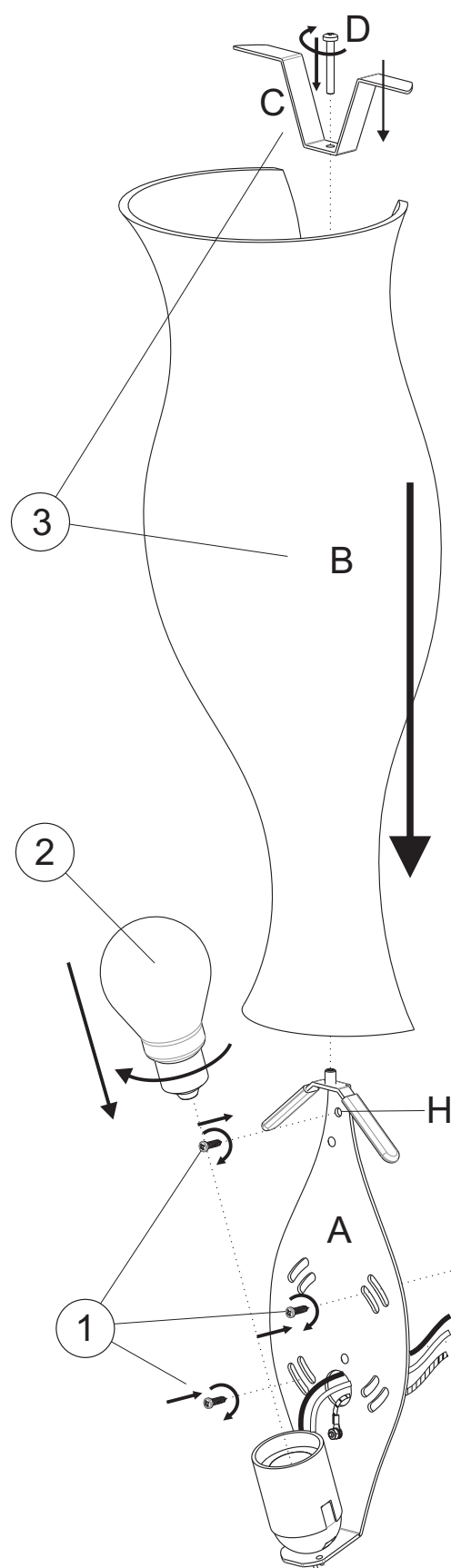

INSTALLATION INSTRUCTIONS

1. Secure the back plate "A" to the wall and connect the wires to the power supply. Add an anchor to hole "H" for additional support.
2. Install the lamp and make sure that it operates properly before installing the glass diffuser.
3. Position the glass diffuser "B" and secure it to the metal plate "A" with the bracket "C" and secure it with screw "D".
4. Restore power.

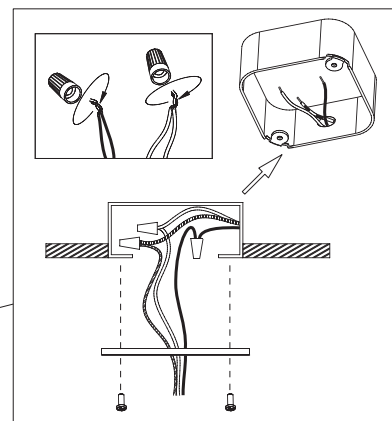

The safety and reliability are guaranteed only when installation instructions are properly followed. Please retain this instruction sheet for future reference.