

Design: Eva Zeisel

Codice: E26: 0703364015252 cromo/bianco
 0703364015352 cromo/ambra
 0703364165252 nichel/bianco
 0703364165352 nichel/ambra
 0703364365252 bianco/bianco
 0703364365352 bianco/ambra
 0703364505252 bronzo/bianco
 0703364505352 bronzo/ambra

GU24: 0703364015288 cromo/bianco
 0703364015388 cromo/ambra
 0703364165288 nichel/bianco
 0703364165388 nichel/ambra
 0703364365288 bianco/bianco
 0703364365388 bianco/ambra
 0703364505288 bronzo/bianco
 0703364505388 bronzo/ambra

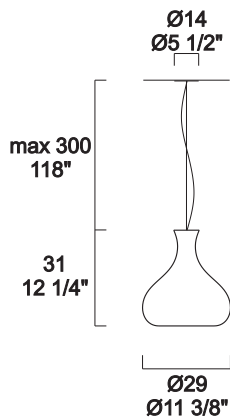

WARNING:

- DISCONNECT POWER BEFORE STARTING INSTALLATION OF FIXTURE.
- INSTALL IN ACCORDANCE WITH THE NATIONAL AND LOCAL CODES.
- FOLLOW DIRECTIONS CAREFULLY TO AVOID SCRATCHING THE GLASS DIFFUSER.

TECHNICAL DATA



LOCATION

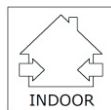

1 X MAX 75W
 E26 TYPE A
 120V / 60Hz

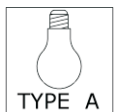

1 X MAX 18W
 TYPE GU24 SBCFL
 120V / 60Hz

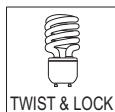

INSTALLATION INSTRUCTIONS

LEUCOS®

SUMMER S
 Suspension

Designed by: Eva Zeisel

LEUCOS USA
 11 Mayfield Avenue
 Edison, NJ 08837 USA
 Phone (732) 225-0010 Fax (732) 225-0250
 info@leucosusa.com
 www.leucosusa.com



FOLLOW THE ASSEMBLY INSTRUCTIONS BY READING THE NUMERICAL PROGRESSION.

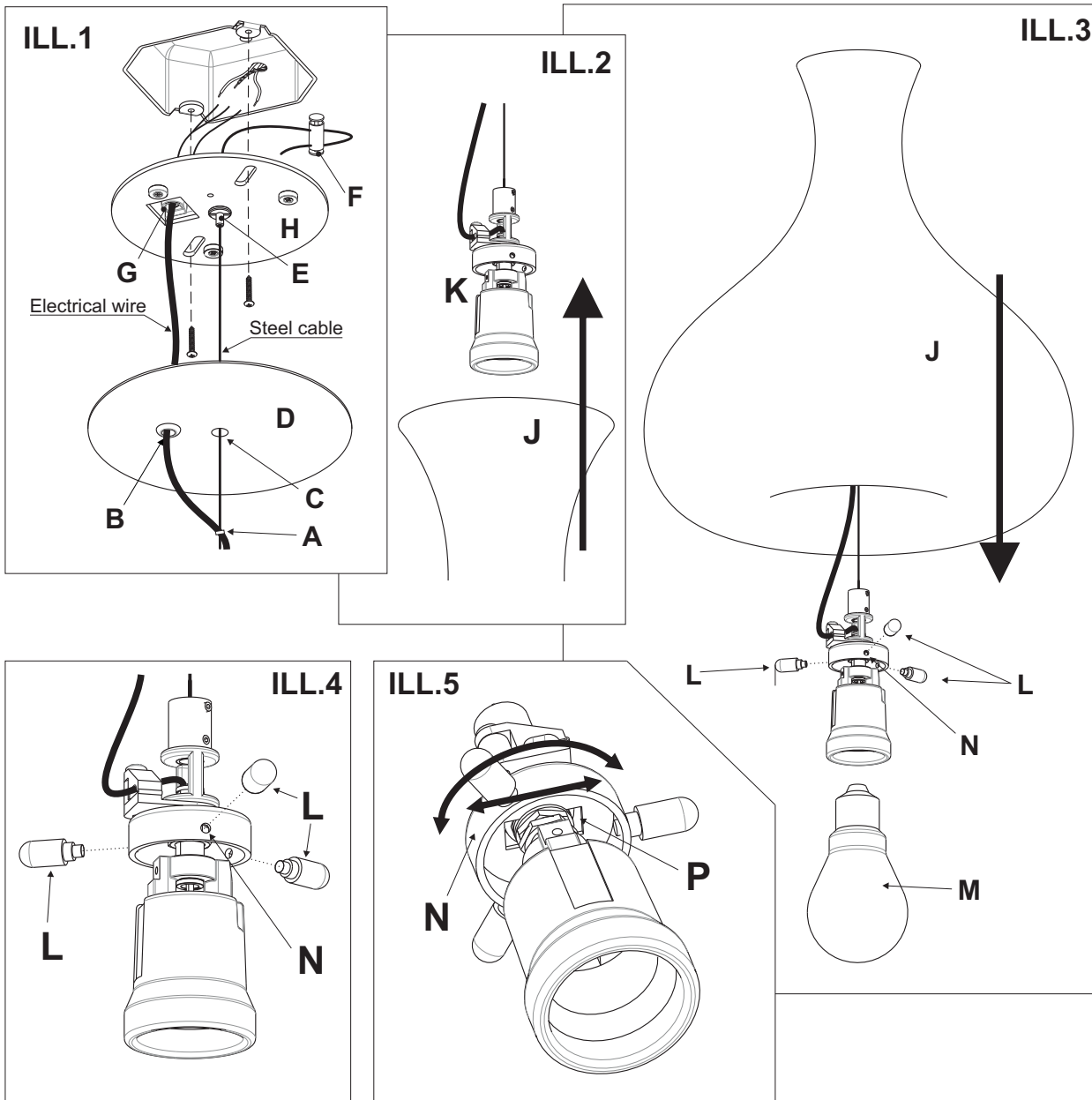

INSTALLATION INSTRUCTIONS

1. **ILL.1.** Guide the electrical wire through the rubber rings “A” and through the side opening “B”.
2. Guide the steel cable through the center opening “C” of the cover “D”.
3. Slightly loosen the fitting “E”. Pass the steel cable through the central hole of the fitting “E”. The fitting is pressured fit. In order to secure the steel cable push the fitting toward the top. Having determined the correct height of the fixture, secure the steel cable by securing the fitting “E”. In order to properly secure the steel cable, we suggest passing the steel cable through fitting “F” at the end of the steel cable.
4. Guide the electrical wires through the plastic clamp “G” then lock it with the plastic screw.
5. Connect the fixture’s electrical wires to supply wire connectors of the proper size leaving excess wire for decorative “swag” below canopy “D”.
6. Install plate “H” to the J-Box.
7. Slide the canopy “D” against the J-Box cover. This will secure without any screws since plate is magnetic.
8. **ILL.2.** Guide the glass diffuser “J” so that the structure “K” enter through the top opening of the diffuser.
9. **ILL.3 and ILL.4.** Secure the three pins “L” in the three holes of the disk “N”.
10. Install the lamp “M” into lampholder.
11. Restore power.
12. **ILL.5:** PLEASE NOTE: IN ORDER TO BALANCE THE GLASS DIFFUSER, ROTATE THE DISK “N” IN THE SLOT “P”.

La sicurezza di questo apparecchio e' garantita solo con l'uso appropriato di queste istruzioni pertanto e' necessario conservarle.

The safety and reliability are guaranteed only when installation instructions are properly followed. Please retain this instruction sheet for future reference.

La securite de cet appareil n'est pas garantie en cas de non-respect de ces instructions, qu'il est necessaire de conserver.

Für die Sicherheit des Beleuchtungskörpers kann nur unter der Voraussetzung garantiert werden, daß die vorliegenden Anleitungen korrekt beachtet werden.

La seguridad del aparato se garantiza sólo utilizando de forma apropiada las siguientes instrucciones, por lo tanto es necesario conservarlas.