

ROUND CLUSTER CANOPY 55 - INDOOR

Leucos Design Lab, 2025

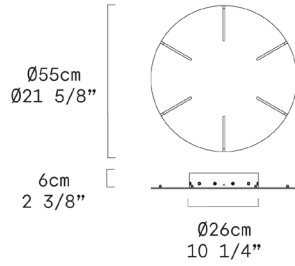

LEUCOS



Discover more

REPLACEABLE LED



TECHNICAL SHEET	
MATERIALS	Metal
DIMENSIONS	Ø55cm [Ø21 5/8"] H6cm [2 3/8"]
DIMMING PROTOCOL	Push-dim; 0/1-10V; DALI On-Off
MARKING	 
NET WEIGHT	10kg

DIMMING PROTOCOL	Push-dim; 0/1-10V; DALI
FINISH (STRUCTURE)	CODE
Matte White	8000345

DIMMING PROTOCOL	On-Off
FINISH (STRUCTURE)	CODE
Matte White	8000344

CONFIGURATION CANOPY + ITEMS

Total maximum weight of installable fixtures (kg)	Maximum wattage (Driver included for dimmable version cod. 8000345)
30 kg	24Vdc 135W

LAMPS (MAX 12 ELEMENTS)

ITEMS	NET WEIGHT (KG) 1x Unite Stacking	LIGHT SOURCE (W)
Stacking S 30 V	1,45	6,25
Stacking S 60 V	2,35	13,7
Stacking S 90 V	3,45	21,25

We reserve the right to change our product specifications.
Please visit www.leucos.com for the latest product information

CANOPY	Round Cluster Canopy 55
QUANTITY OF LAMPS	1 X Stacking S 30 V
	1 X Stacking S 60 V
	1 x Stacking S 90 V
TOT SOURCE	41,2W
TOT NET WEIGHT	7,25Kg

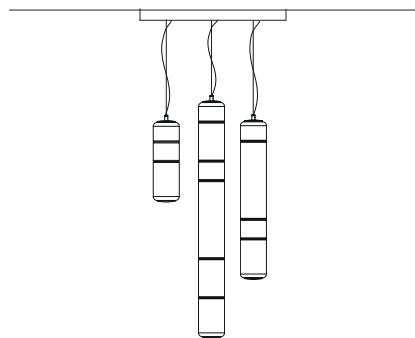

CANOPY	Round Cluster Canopy 55
QUANTITY OF LAMPS	3 x Stacking S 30 V
	3 X Stacking S 60 V
	1 X Stacking S 90 V
TOT SOURCE	81,1W
TOT NET WEIGHT	14,85Kg

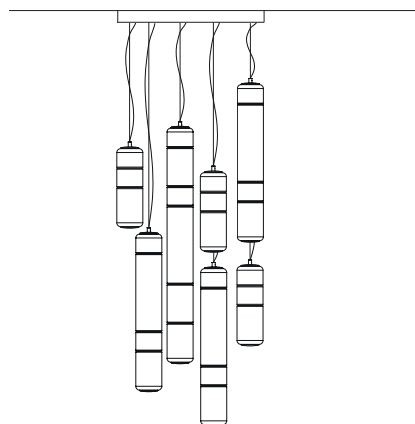

CANOPY	Round Cluster Canopy 55
QUANTITY OF LAMPS	6 x Stacking S 60 V
TOT SOURCE	81,2W
TOT NET WEIGHT	14,01Kg

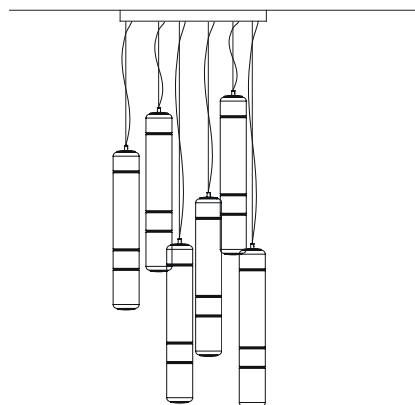

We reserve the right to change our product specifications.
Please visit www.leucos.com for the latest product information